

香港知識產權公報

Hong Kong Intellectual Property Journal

2017年3月24日

24 March 2017



目錄 Contents

根據註冊外觀設計條例第25條註冊的外觀設計
Designs Registered under section 25 of the Registered
Designs Ordinance

[按註冊編號排列](#)
[Arranged by Registration Number](#)

根據註冊外觀設計條例(第522章)公布的其他公告
Other Notices Published under the Registered Designs
Ordinance (Cap. 522)

[根據註冊外觀設計條例第28條，註冊外觀設計因未繳續期費而停止有效](#)
[Registered Designs Ceased through Non-payment of Renewal Fees under](#)
[section 28 of the Registered Designs Ordinance](#)

[根據註冊外觀設計規則第31條刪除的註冊外觀設計](#)
[Registered Designs Removed under section 31 of the Registered](#)
[Designs Rules](#)

以下事項沒有記錄
No Records for the Following Matters

[根據註冊外觀設計條例第30條放棄的外觀設計的註冊](#)
[Surrender of Registration of Design under section 30 of the](#)
[Registered Designs Ordinance](#)

[根據註冊外觀設計規則第37條，向處長作出轉介](#)
[Reference to Registrar under section 37 of the Registered Designs](#)
[Rules](#)

[根據註冊外觀設計條例第45條，撤銷註冊](#)
[Revocation of Registration under section 45 of the Registered](#)

Designs Ordinance

根據註冊外觀設計規則第46條，向法院作出轉介

Reference to Court under section 46 of the Registered Designs Rules

根據註冊外觀設計規則第63條對不符合規定之處作出糾正

Rectification of Irregularities under section 63 of the Registered Designs Rules

根據註冊外觀設計條例第66條，糾正註冊紀錄冊

Rectification of Register under section 66 of the Registered Designs Ordinance

根據註冊外觀設計條例第 67 條，更正註冊紀錄冊內的錯誤

Correction of Errors in Register under section 67 of the Registered Designs Ordinance

根據註冊外觀設計條例第67及76條，更正註冊紀錄冊內及已提交文件中的錯誤

Correction of Errors in Register and in Filed Documents under sections 67 and 76 of the Registered Designs Ordinance

根據註冊外觀設計條例第76條，更正已提交文件中的錯誤

Correction of Errors in Filed Documents under section 76 of the Registered Designs Ordinance

勘誤

Corrigendum

註冊外觀設計公告註釋

Notes on advertisements of registration of designs

方括號表示下列資料：

Square brackets indicate the following data：

- [11] 註冊編號 Registration number / 聯合王國註冊編號 United Kingdom registration number

- [15] 註冊日期 Registration date / 當作註冊日期 Deemed registration date / 聯合王國註冊日期 United Kingdom registration date

- [17] 註冊有效期屆滿日期 Expiry date of the period of registration

- [22] 提交日期 Filing date / 當作提交日期 Deemed filing date / 聯合王國提交日期 United Kingdom filing date

- [30] 聲稱享有的優先權 (提交日期 / 巴黎公約國或世界貿易組織成員 / 申請編號) Priority claimed (filing date / Paris Convention country or WTO member / application number)

- [51] 國際外觀設計分類號 (洛迦諾分類號) International Classification of designs (Locarno Classification)

- [54] 物品 Article

- [55] 外觀設計的表述 Representation of the design

- [62] 分開前的申請編號及提交日期 Application number before division and filing date

- [66] 過往註冊的聯繫外觀設計註冊編號 / 日期 Registration No. / Date of Previous Registration for Association

- [72] 設計人 Designer

- [73] 擁有人姓名和地址 Name and address of the owner

- [74] 代理人 Agent / 送達地址 Address for service



香港特別行政區政府知識產權署外觀設計註冊處
The Government of the Hong Kong Special Administrative Region
Designs Registry, Intellectual Property Department

根據註冊外觀設計條例第25條註冊的外觀設計

Designs registered under section 25 of the Registered Designs Ordinance

按註冊編號排列

Arranged by Registration Number

- [11] 1601457.7
- [15] 28-07-2016
- [30] 29-01-2016 / EM / 002964247
- [51] C1. 21 - 01
- [54] 比例汽車模型
Scale car model
- [73] FCA ITALY S.p.A.
CORSO GIOVANNI AGNELLI 200,
I-10135 TORINO ITALY,
ITALY
- [74] China Patent Agent (H.K.) Ltd.
22/F, Great Eagle Centre,
23 Harbour Road, Wanchai,
HONG KONG



-
- [11] 1601614.1
 - [15] 25-08-2016
 - [30] 26-02-2016 / CA / 167213
 - [51] C1. 30 - 99
 - [54] 動物糞便收集裝置
Animal waste collection device
 - [73] 9252-8595 QUÉBEC INC.
1350 rue Mazurette, Suite 228,
Montréal (Québec) H4N 1H2,

CANADA

[74] CHAN, TANG & KWOK

Rooms 2503-04, 25/F.,

Shanghai Industrial Investment Building,

48-62 Hennessy Road, Wanchai, HONG KONG



[11] 1601773.7M001

[15] 15-09-2016

[30] 21-04-2016 / EM / 003076983

[51] C1. 7 - 01

[54] 飲用杯

Drinking cup

[73] Koninklijke Philips N.V.

High Tech Campus 5,

5656 AE, Eindhoven,

NETHERLANDS

[74] Wilkinson & Grist

6th Floor, Prince's Building,

Chater Road,

HONG KONG



[11] 1601773.7M002

[15] 15-09-2016

[30] 21-04-2016 / EM / 003076983

[51] C1. 7 - 01

[54] 飲用杯

Drinking cup

[73] Koninklijke Philips N.V.

High Tech Campus 5,

5656 AE, Eindhoven,

NETHERLANDS

[74] Wilkinson & Grist

6th Floor, Prince's Building,

Chater Road,

HONG KONG



[11] 1601773.7M003

[15] 15-09-2016

[30] 21-04-2016 / EM / 003076983

[51] C1. 7 - 01

[54] 飲用杯

Drinking cup

[73] Koninklijke Philips N.V.

High Tech Campus 5,

5656 AE, Eindhoven,

NETHERLANDS

[74] Wilkinson & Grist

6th Floor, Prince's Building,

Chater Road,

HONG KONG



[11] 1601774.9M001

[15] 15-09-2016

[30] 15-03-2016 / MA, AL, NO, OM, SG, CH, TN, TR, UA, EM / DM/089
815

[51] C1. 10 - 02

[54] 手錶

Wristwatch

[73] SWATCH AG (SWATCH SA) (SWATCH LTD.)

Jakob-Stämpfli-Strasse 94,

CH-2502 Biel/Bienne,

SWITZERLAND

[74] Spruson & Ferguson (Hong Kong) Limited

5001 Hopewell Centre, 183 Queen's Road East, Wan Chai, Hong
Kong



[11] 1601774.9M002

[15] 15-09-2016

[30] 15-03-2016 / MA, AL, NO, OM, SG, CH, TN, TR, UA, EM / DM/089
815

[51] C1. 10 - 02

[54] 手錶

Wristwatch

[73] SWATCH AG (SWATCH SA) (SWATCH LTD.)

Jakob-Stä mpfli-Strasse 94,
CH-2502 Biel/Bienne,
SWITZERLAND

[74] Spruson & Ferguson (Hong Kong) Limited

5001 Hopewell Centre, 183 Queen's Road East, Wan Chai, Hong
Kong



[11] 1601775.2M001

[15] 15-09-2016

[30] 15-03-2016 / MA, AL, NO, OM, SG, CH, TN, TR, UA, EM / DM/091
792

[51] C1. 10 - 02

[54] 手錶

Wristwatch

[73] SWATCH AG (SWATCH SA) (SWATCH LTD.)

Jakob-Stä mpfli-Strasse 94,
CH-2502 Biel/Bienne,
SWITZERLAND

[74] Spruson & Ferguson (Hong Kong) Limited

5001 Hopewell Centre, 183 Queen's Road East, Wan Chai, Hong
Kong



- [11] 1601775.2M002
[15] 15-09-2016
[30] 15-03-2016 / MA, AL, NO, OM, SG, CH, TN, TR, UA, EM / DM/091
792
[51] C1. 10 - 02
[54] 手錶
Wristwatch
[73] SWATCH AG (SWATCH SA) (SWATCH LTD.)
Jakob-Stä mpfli-Strasse 94,
CH-2502 Biel/Bienne,
SWITZERLAND
[74] Spruson & Ferguson (Hong Kong) Limited
5001 Hopewell Centre, 183 Queen's Road East, Wan Chai, Hong
Kong



-
- [11] 1601775.2M003
[15] 15-09-2016
[30] 15-03-2016 / MA, AL, NO, OM, SG, CH, TN, TR, UA, EM / DM/091
792
[51] C1. 10 - 02
[54] 手錶
Wristwatch
[73] SWATCH AG (SWATCH SA) (SWATCH LTD.)
Jakob-Stä mpfli-Strasse 94,
CH-2502 Biel/Bienne,
SWITZERLAND
[74] Spruson & Ferguson (Hong Kong) Limited
5001 Hopewell Centre, 183 Queen's Road East, Wan Chai, Hong
Kong



[11] 1601775.2M004

[15] 15-09-2016

[30] 15-03-2016 / MA, AL, NO, OM, SG, CH, TN, TR, UA, EM / DM/091
792

[51] C1. 10 - 02

[54] 手錶

Wristwatch

[73] SWATCH AG (SWATCH SA) (SWATCH LTD.)

Jakob-Stämpfli-Strasse 94,

CH-2502 Biel/Bienne,

SWITZERLAND

[74] Spruson & Ferguson (Hong Kong) Limited

5001 Hopewell Centre, 183 Queen's Road East, Wan Chai, Hong
Kong



[11] 1601775.2M005

[15] 15-09-2016

[30] 15-03-2016 / MA, AL, NO, OM, SG, CH, TN, TR, UA, EM / DM/091
792

[51] C1. 10 - 02

[54] 手錶

Wristwatch

[73] SWATCH AG (SWATCH SA) (SWATCH LTD.)

Jakob-Stä mpfli-Strasse 94,
CH-2502 Biel/Bienne,
SWITZERLAND

[74] Spruson & Ferguson (Hong Kong) Limited

5001 Hopewell Centre, 183 Queen's Road East, Wan Chai, Hong
Kong



[11] 1601775.2M006

[15] 15-09-2016

[30] 15-03-2016 / MA, AL, NO, OM, SG, CH, TN, TR, UA, EM / DM/091
792

[51] C1. 10 - 02

[54] 手錶

Wristwatch

[73] SWATCH AG (SWATCH SA) (SWATCH LTD.)

Jakob-Stä mpfli-Strasse 94,
CH-2502 Biel/Bienne,
SWITZERLAND

[74] Spruson & Ferguson (Hong Kong) Limited

5001 Hopewell Centre, 183 Queen's Road East, Wan Chai, Hong
Kong



- [11] 1601775.2M007
[15] 15-09-2016
[30] 15-03-2016 / MA, AL, NO, OM, SG, CH, TN, TR, UA, EM / DM/091
792
[51] C1. 10 - 02
[54] 手錶
Wristwatch
[73] SWATCH AG (SWATCH SA) (SWATCH LTD.)
Jakob-Stä mpfli-Strasse 94,
CH-2502 Biel/Bienne,
SWITZERLAND
[74] Spruson & Ferguson (Hong Kong) Limited
5001 Hopewell Centre, 183 Queen's Road East, Wan Chai, Hong
Kong



-
- [11] 1601775.2M008
[15] 15-09-2016
[30] 15-03-2016 / MA, AL, NO, OM, SG, CH, TN, TR, UA, EM / DM/091
792
[51] C1. 10 - 02
[54] 手錶
Wristwatch
[73] SWATCH AG (SWATCH SA) (SWATCH LTD.)
Jakob-Stä mpfli-Strasse 94,
CH-2502 Biel/Bienne,
SWITZERLAND
[74] Spruson & Ferguson (Hong Kong) Limited
5001 Hopewell Centre, 183 Queen's Road East, Wan Chai, Hong
Kong



[11] 1601775.2M009

[15] 15-09-2016

[30] 15-03-2016 / MA, AL, NO, OM, SG, CH, TN, TR, UA, EM / DM/091
792

[51] C1. 10 - 02

[54] 手錶

Wristwatch

[73] SWATCH AG (SWATCH SA) (SWATCH LTD.)

Jakob-Stämpfli-Strasse 94,

CH-2502 Biel/Bienne,

SWITZERLAND

[74] Spruson & Ferguson (Hong Kong) Limited

5001 Hopewell Centre, 183 Queen's Road East, Wan Chai, Hong
Kong



[11] 1601775.2M010

[15] 15-09-2016

[30] 15-03-2016 / MA, AL, NO, OM, SG, CH, TN, TR, UA, EM / DM/091
792

[51] C1. 10 - 02

[54] 手錶

Wristwatch

[73] SWATCH AG (SWATCH SA) (SWATCH LTD.)

Jakob-Stä mpfli-Strasse 94,
CH-2502 Biel/Bienne,
SWITZERLAND

[74] Spruson & Ferguson (Hong Kong) Limited

5001 Hopewell Centre, 183 Queen's Road East, Wan Chai, Hong
Kong



[11] 1601775.2M011

[15] 15-09-2016

[30] 15-03-2016 / MA, AL, NO, OM, SG, CH, TN, TR, UA, EM / DM/091
792

[51] C1. 10 - 02

[54] 手錶

Wristwatch

[73] SWATCH AG (SWATCH SA) (SWATCH LTD.)

Jakob-Stä mpfli-Strasse 94,
CH-2502 Biel/Bienne,
SWITZERLAND

[74] Spruson & Ferguson (Hong Kong) Limited

5001 Hopewell Centre, 183 Queen's Road East, Wan Chai, Hong
Kong



- [11] 1601775.2M012
[15] 15-09-2016
[30] 15-03-2016 / MA, AL, NO, OM, SG, CH, TN, TR, UA, EM / DM/091
792
[51] C1. 10 - 02
[54] 手錶
Wristwatch
[73] SWATCH AG (SWATCH SA) (SWATCH LTD.)
Jakob-Stä mpfli-Strasse 94,
CH-2502 Biel/Bienne,
SWITZERLAND
[74] Spruson & Ferguson (Hong Kong) Limited
5001 Hopewell Centre, 183 Queen's Road East, Wan Chai, Hong
Kong



-
- [11] 1601775.2M013
[15] 15-09-2016
[30] 15-03-2016 / MA, AL, NO, OM, SG, CH, TN, TR, UA, EM / DM/091
792
[51] C1. 10 - 02
[54] 手錶
Wristwatch
[73] SWATCH AG (SWATCH SA) (SWATCH LTD.)
Jakob-Stä mpfli-Strasse 94,
CH-2502 Biel/Bienne,
SWITZERLAND
[74] Spruson & Ferguson (Hong Kong) Limited
5001 Hopewell Centre, 183 Queen's Road East, Wan Chai, Hong
Kong



[11] 1601775.2M014

[15] 15-09-2016

[30] 15-03-2016 / MA, AL, NO, OM, SG, CH, TN, TR, UA, EM / DM/091
792

[51] C1. 10 - 02

[54] 手錶

Wristwatch

[73] SWATCH AG (SWATCH SA) (SWATCH LTD.)

Jakob-Stä mpfli-Strasse 94,

CH-2502 Biel/Bienne,

SWITZERLAND

[74] Spruson & Ferguson (Hong Kong) Limited

5001 Hopewell Centre, 183 Queen's Road East, Wan Chai, Hong
Kong



[11] 1601775.2M015

[15] 15-09-2016

[30] 15-03-2016 / MA, AL, NO, OM, SG, CH, TN, TR, UA, EM / DM/091
792

[51] C1. 10 - 02

[54] 手錶

Wristwatch

[73] SWATCH AG (SWATCH SA) (SWATCH LTD.)

Jakob-Stä mpfli-Strasse 94,
CH-2502 Biel/Bienne,
SWITZERLAND

[74] Spruson & Ferguson (Hong Kong) Limited

5001 Hopewell Centre, 183 Queen's Road East, Wan Chai, Hong
Kong



[11] 1601775.2M016

[15] 15-09-2016

[30] 15-03-2016 / MA, AL, NO, OM, SG, CH, TN, TR, UA, EM / DM/091
792

[51] C1. 10 - 02

[54] 手錶

Wristwatch

[73] SWATCH AG (SWATCH SA) (SWATCH LTD.)

Jakob-Stä mpfli-Strasse 94,
CH-2502 Biel/Bienne,
SWITZERLAND

[74] Spruson & Ferguson (Hong Kong) Limited

5001 Hopewell Centre, 183 Queen's Road East, Wan Chai, Hong
Kong



[11] 1601775.2M017

[15] 15-09-2016

[30] 15-03-2016 / MA, AL, NO, OM, SG, CH, TN, TR, UA, EM / DM/091
792

[51] C1. 10 - 02

[54] 手錶

Wristwatch

[73] SWATCH AG (SWATCH SA) (SWATCH LTD.)

Jakob-Stä mpfli-Strasse 94,

CH-2502 Biel/Bienne,

SWITZERLAND

[74] Spruson & Ferguson (Hong Kong) Limited

5001 Hopewell Centre, 183 Queen's Road East, Wan Chai, Hong
Kong



[11] 1601775.2M018

[15] 15-09-2016

[30] 15-03-2016 / MA, AL, NO, OM, SG, CH, TN, TR, UA, EM / DM/091
792

[51] C1. 10 - 02

[54] 手錶

Wristwatch

[73] SWATCH AG (SWATCH SA) (SWATCH LTD.)

Jakob-Stä mpfli-Strasse 94,

CH-2502 Biel/Bienne,

SWITZERLAND

[74] Spruson & Ferguson (Hong Kong) Limited

5001 Hopewell Centre, 183 Queen's Road East, Wan Chai, Hong
Kong



[11] 1601775.2M019

[15] 15-09-2016

[30] 15-03-2016 / MA, AL, NO, OM, SG, CH, TN, TR, UA, EM / DM/091
792

[51] C1. 10 - 02

[54] 手錶

Wristwatch

[73] SWATCH AG (SWATCH SA) (SWATCH LTD.)

Jakob-Stä mpfli-Strasse 94,

CH-2502 Biel/Bienne,

SWITZERLAND

[74] Spruson & Ferguson (Hong Kong) Limited

5001 Hopewell Centre, 183 Queen's Road East, Wan Chai, Hong
Kong



[11] 1601775.2M020

[15] 15-09-2016

[30] 15-03-2016 / MA, AL, NO, OM, SG, CH, TN, TR, UA, EM / DM/091
792

[51] C1. 10 - 02

[54] 手錶

Wristwatch

[73] SWATCH AG (SWATCH SA) (SWATCH LTD.)

Jakob-Stä mpfli-Strasse 94,
CH-2502 Biel/Bienne,
SWITZERLAND

[74] Spruson & Ferguson (Hong Kong) Limited

5001 Hopewell Centre, 183 Queen's Road East, Wan Chai, Hong
Kong



[11] 1601775.2M021

[15] 15-09-2016

[30] 15-03-2016 / MA, AL, NO, OM, SG, CH, TN, TR, UA, EM / DM/091
792

[51] C1. 10 - 02

[54] 手錶

Wristwatch

[73] SWATCH AG (SWATCH SA) (SWATCH LTD.)

Jakob-Stä mpfli-Strasse 94,
CH-2502 Biel/Bienne,
SWITZERLAND

[74] Spruson & Ferguson (Hong Kong) Limited

5001 Hopewell Centre, 183 Queen's Road East, Wan Chai, Hong
Kong



- [11] 1601775.2M022
[15] 15-09-2016
[30] 15-03-2016 / MA, AL, NO, OM, SG, CH, TN, TR, UA, EM / DM/091
792
[51] C1. 10 - 02
[54] 手錶
Wristwatch
[73] SWATCH AG (SWATCH SA) (SWATCH LTD.)
Jakob-Stä mpfli-Strasse 94,
CH-2502 Biel/Bienne,
SWITZERLAND
[74] Spruson & Ferguson (Hong Kong) Limited
5001 Hopewell Centre, 183 Queen's Road East, Wan Chai, Hong
Kong



-
- [11] 1601775.2M023
[15] 15-09-2016
[30] 15-03-2016 / MA, AL, NO, OM, SG, CH, TN, TR, UA, EM / DM/091
792
[51] C1. 10 - 02
[54] 手錶
Wristwatch
[73] SWATCH AG (SWATCH SA) (SWATCH LTD.)
Jakob-Stä mpfli-Strasse 94,
CH-2502 Biel/Bienne,
SWITZERLAND
[74] Spruson & Ferguson (Hong Kong) Limited
5001 Hopewell Centre, 183 Queen's Road East, Wan Chai, Hong
Kong



[11] 1601775.2M024

[15] 15-09-2016

[30] 15-03-2016 / MA, AL, NO, OM, SG, CH, TN, TR, UA, EM / DM/091
792

[51] C1. 10 - 02

[54] 手錶

Wristwatch

[73] SWATCH AG (SWATCH SA) (SWATCH LTD.)

Jakob-Stä mpfli-Strasse 94,

CH-2502 Biel/Bienne,

SWITZERLAND

[74] Spruson & Ferguson (Hong Kong) Limited

5001 Hopewell Centre, 183 Queen's Road East, Wan Chai, Hong
Kong



[11] 1601775.2M025

[15] 15-09-2016

[30] 15-03-2016 / MA, AL, NO, OM, SG, CH, TN, TR, UA, EM / DM/091
792

[51] C1. 10 - 02

[54] 手錶

Wristwatch

[73] SWATCH AG (SWATCH SA) (SWATCH LTD.)

Jakob-Stä mpfli-Strasse 94,
CH-2502 Biel/Bienne,
SWITZERLAND

[74] Spruson & Ferguson (Hong Kong) Limited

5001 Hopewell Centre, 183 Queen's Road East, Wan Chai, Hong
Kong



[11] 1601775.2M026

[15] 15-09-2016

[30] 15-03-2016 / MA, AL, NO, OM, SG, CH, TN, TR, UA, EM / DM/091
792

[51] C1. 10 - 02

[54] 手錶

Wristwatch

[73] SWATCH AG (SWATCH SA) (SWATCH LTD.)

Jakob-Stä mpfli-Strasse 94,
CH-2502 Biel/Bienne,
SWITZERLAND

[74] Spruson & Ferguson (Hong Kong) Limited

5001 Hopewell Centre, 183 Queen's Road East, Wan Chai, Hong
Kong



- [11] 1601775.2M027
[15] 15-09-2016
[30] 15-03-2016 / MA, AL, NO, OM, SG, CH, TN, TR, UA, EM / DM/091
792
[51] C1. 10 - 02
[54] 手錶
Wristwatch
[73] SWATCH AG (SWATCH SA) (SWATCH LTD.)
Jakob-Stä mpfli-Strasse 94,
CH-2502 Biel/Bienne,
SWITZERLAND
[74] Spruson & Ferguson (Hong Kong) Limited
5001 Hopewell Centre, 183 Queen's Road East, Wan Chai, Hong
Kong



-
- [11] 1601776.4M001
[15] 15-09-2016
[30] 15-03-2016 / MA, AL, NO, OM, SG, CH, TN, TR, UA, EM / DM/089
814
[51] C1. 10 - 02
[54] 手錶
Wristwatch
[73] SWATCH AG (SWATCH SA) (SWATCH LTD.)
Jakob-Stä mpfli-Strasse 94,
CH-2502 Biel/Bienne,
SWITZERLAND
[74] Spruson & Ferguson (Hong Kong) Limited
5001 Hopewell Centre, 183 Queen's Road East, Wan Chai, Hong
Kong



[11] 1601776.4M002

[15] 15-09-2016

[30] 15-03-2016 / MA, AL, NO, OM, SG, CH, TN, TR, UA, EM / DM/089
814

[51] C1. 10 - 02

[54] 手錶

Wristwatch

[73] SWATCH AG (SWATCH SA) (SWATCH LTD.)

Jakob-Stä mpfli-Strasse 94,

CH-2502 Biel/Bienne,

SWITZERLAND

[74] Spruson & Ferguson (Hong Kong) Limited

5001 Hopewell Centre, 183 Queen's Road East, Wan Chai, Hong
Kong



[11] 1601776.4M003

[15] 15-09-2016

[30] 15-03-2016 / MA, AL, NO, OM, SG, CH, TN, TR, UA, EM / DM/089
814

[51] C1. 10 - 02

[54] 手錶

Wristwatch

[73] SWATCH AG (SWATCH SA) (SWATCH LTD.)

Jakob-Stä mpfli-Strasse 94,
CH-2502 Biel/Bienne,
SWITZERLAND

[74] Spruson & Ferguson (Hong Kong) Limited

5001 Hopewell Centre, 183 Queen's Road East, Wan Chai, Hong
Kong



[11] 1601776.4M004

[15] 15-09-2016

[30] 15-03-2016 / MA, AL, NO, OM, SG, CH, TN, TR, UA, EM / DM/089
814

[51] C1. 10 - 02

[54] 手錶

Wristwatch

[73] SWATCH AG (SWATCH SA) (SWATCH LTD.)

Jakob-Stä mpfli-Strasse 94,
CH-2502 Biel/Bienne,
SWITZERLAND

[74] Spruson & Ferguson (Hong Kong) Limited

5001 Hopewell Centre, 183 Queen's Road East, Wan Chai, Hong
Kong



- [11] 1601776.4M005
[15] 15-09-2016
[30] 15-03-2016 / MA, AL, NO, OM, SG, CH, TN, TR, UA, EM / DM/089
814
[51] C1. 10 - 02
[54] 手錶
Wristwatch
[73] SWATCH AG (SWATCH SA) (SWATCH LTD.)
Jakob-Stämpfli-Strasse 94,
CH-2502 Biel/Bienne,
SWITZERLAND
[74] Spruson & Ferguson (Hong Kong) Limited
5001 Hopewell Centre, 183 Queen's Road East, Wan Chai, Hong
Kong



-
- [11] 1601777.6
[15] 15-09-2016
[30] 18-03-2016 / EM, JP, KR, SG, CH, TR / DM/090 116
[51] C1. 10 - 07
[54] 錶面
Watch dial
[73] RICHEMONT INTERNATIONAL SA
Route des Biches 10,
CH - 1752 Villars-sur-Glâne,
SWITZERLAND
[74] WENPING & CO.
1701 Tung Wai Commercial Building,
111 Gloucester Road,
HONG KONG

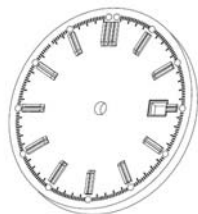

-
- [11] 1601778.8
[15] 15-09-2016
[30] 18-03-2016 / EM, JP, KR, SG, CH, TR / DM/090 116
[51] C1. 10 - 02
[54] 錶
Watch
[73] RICHEMONT INTERNATIONAL SA
Route des Biches 10,
CH - 1752 Villars-sur-Glâne,
SWITZERLAND
[74] WENPING & CO.
1701 Tung Wai Commercial Building,
111 Gloucester Road,
HONG KONG



-
- [11] 1601780.2M001
[15] 19-09-2016
[30] 25-03-2016 / JP / 006495 of 2016
[51] C1. 9 - 03
[54] 包裝盒
Packaging box
[73] KYB Corporation

World Trade Center Bldg., 4-1, Hamamatsu-cho 2-chome, Minato-ku, Tokyo

JAPAN

[74] Wilkinson & Grist

6th Floor, Prince's Building, Chater Road,
HONG KONG

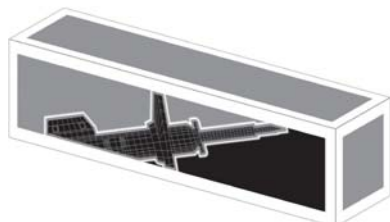

[11] 1601780.2M002

[15] 19-09-2016

[30] 25-03-2016 / JP / 006565 of 2016

[51] C1. 9 - 03

[54] 包裝盒

Packaging box

[73] KYB Corporation

World Trade Center Bldg., 4-1, Hamamatsu-cho 2-chome, Minato-ku, Tokyo

JAPAN

[74] Wilkinson & Grist

6th Floor, Prince's Building, Chater Road,
HONG KONG



[11] 1601782.6

[15] 19-09-2016

[51] C1. 21 - 03

[54] 健身器材

A fitness equipment

[73] 李炫錫

中國內地廣東省東莞市常平鎮東田麗園彩田居18棟601

[74] 香港專利商標代理有限公司

香港

香港皇后大道西419K

博仕臺10樓A室



[11] 1601783.8M001

[15] 19-09-2016

[30] 18-05-2016 / CH / 142300

[51] C1. 9 - 03, 05

[54] 包裝

Packaging

[73] Soci é t é des Produits Nestl é S.A.

1800 Vevey,

SWITZERLAND

[74] Deacons

5th Floor,

Alexandra House, Central,

HONG KONG

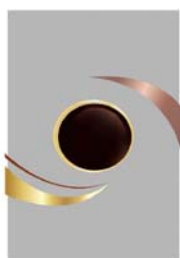

[11] 1601783.8M002

[15] 19-09-2016

[30] 18-05-2016 / CH / 142300

[51] C1. 9 - 03, 05

[54] 包裝

Packaging

[73] Soci ẽ t ẽ des Produits Nestl ẽ S.A.
1800 Vevey,
SWITZERLAND

[74] Deacons
5th Floor,
Alexandra House, Central,
HONG KONG

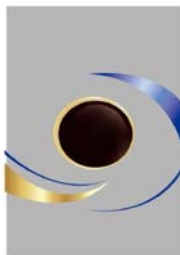

[11] 1601784.0

[15] 19-09-2016

[30] 31-08-2016 / CN / 201630459456.4

[51] C1. 10 - 05

[54] 傳感器

Sensor

[73] 關沛棠

香港九龍

長沙灣青山道650-652號

益大工業大廈5樓519室

[74] 天標知識產權代理有限公司

香港九龍

尖沙咀加連威老道14號

加連威大廈4樓A座



-
- [11] 1601785.3
[15] 19-09-2016
[30] 29-06-2016 / KR / 30-2016-0031710
[51] C1. 14 - 02
[54] 便携式計算機
Portable computer
[73] Samsung Electronics Co., Ltd.
129, Samsung-ro, Yeongtong-gu, Suwon-si,
Gyeonggi-do, 16677 Republic of Korea,
Korea, Republic of
[74] GLOBAL PATENT INTELLECTUAL PROPERTY CO., LIMITED
Room 603, 6/F, Hang Pont Commercial Building,
31 Tonkin Street, Cheung Sha Wan, Kowloon,
HongKong, HONG KONG



-
- [11] 1601787.7
[15] 20-09-2016
[51] C1. 9 - 03
[54] 包裝盒
Packing box
[73] 蘇兆明
香港屯門建發街22號新興工業大廈11樓10室
[74] 蘇兆明
香港
屯門建發街22號
新興工業大廈11樓10室



[11] 1601788.9M001

[15] 20-09-2016

[51] C1. 7 - 05

[54] 潔廁凝膠

Toilet bowl cleaning gel

[73] Consumer Care (Asia Pacific) Limited

香港九龍

慈雲山慈愛苑

愛康閣L座1806室

[74] Consumer Care (Asia Pacific) Ltd.

香港九龍

慈雲山慈愛苑

愛康閣L座1806室



[11] 1601788.9M002

[15] 20-09-2016

[51] C1. 7 - 05

[54] 迷你型潔廁凝膠

Mini type toilet bowl cleaning gel

[73] Consumer Care (Asia Pacific) Limited

香港九龍

慈雲山慈愛苑

- 愛康閣L座1806室
[74] Consumer Care (Asia Pacific) Limited
香港九龍
慈雲山慈愛苑
愛康閣L座1806室

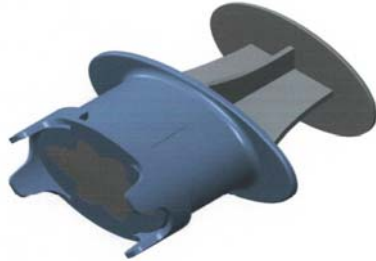

-
- [11] 1601789.1M001
[15] 20-09-2016
[30] 11-04-2016 / EM, NO, SG, CH / DM/090 192
[51] C1. 7 - 02
[54] 煮咖啡器
Coffee maker
[73] PI-DESIGN AG
Kantonsstrasse 100,
CH-6234 Triengen,
SWITZERLAND
[74] WENPING & CO.
1701 Tung Wai Commercial Building,
111 Gloucester Road,
HONG KONG



-
- [11] 1601789.1M002
[15] 20-09-2016

[30] 11-04-2016 / EM, NO, SG, CH / DM/090 192

[51] C1. 7 - 01

[54] 壺

Jug

[73] PI-DESIGN AG

Kantonsstrasse 100,

CH-6234 Triengen,

SWITZERLAND

[74] WENPING & CO.

1701 Tung Wai Commercial Building,

111 Gloucester Road,

HONG KONG



[11] 1601790.3M001

[15] 20-09-2016

[51] C1. 13 - 03

[54] 插頭轉接器

Plug adaptor

[73] DG International Holdings Limited

Unit 1-2 Mill Hill Industrial Estate,

Flower Lane, Mill Hill,

London, NW7 2HU, UNITED KINGDOM

[74] AWA Asia Limited

Suite 901, Lee Garden One,

33 Hysan Avenue,

Causeway Bay, HONG KONG

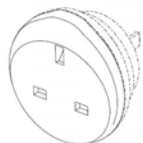

[11] 1601790.3M002

[15] 20-09-2016

[51] C1. 13 - 03

[54] 插頭轉接器

Plug adaptor

[73] DG International Holdings Limited

Unit 1-2 Mill Hill Industrial Estate,

Flower Lane, Mill Hill,

London, NW7 2HU, UNITED KINGDOM

[74] AWA Asia Limited

Suite 901, Lee Garden One,

33 Hysan Avenue,

Causeway Bay, HONG KONG



[11] 1601790.3M003

[15] 20-09-2016

[51] C1. 13 - 03

[54] 插頭轉接器

Plug adaptor

[73] DG International Holdings Limited

Unit 1-2 Mill Hill Industrial Estate,

Flower Lane, Mill Hill,

London, NW7 2HU, UNITED KINGDOM

- [74] AWA Asia Limited
Suite 901, Lee Garden One,
33 Hysan Avenue,
Causeway Bay, HONG KONG



[11] 1601791.5

[15] 20-09-2016

[51] C1. 2 - 04

[54] 鞋面設計

Shoe upper design

[73] 港昌鞋業(香港)有限公司

香港新界葵涌健康街18號恒亞中心6樓12-14室

[74] KONG CHEONG SHOES (HK) LTD. (Attention to ZOE WONG)

香港新界葵涌

健康街18號

恒亞中心6樓12-14室



[11] 1601792.7

[15] 20-09-2016

[51] C1. 10 - 02

[54] 手錶

Watch

[73] HONG KONG PRECISION ELECTRONICS COMPANY LIMITED
Units 1-12, 10/F, Hope Sea Industrial Centre,
26 Lam Hing Street, Kowloon Bay, Kowloon,
HONG KONG

[74] CHAN, TANG & KWOK
Rooms 2503-04, 25/F.,
Shanghai Industrial Investment Building,
48-62 Hennessy Road, Wanchai, HONG KONG



[11] 1601793.9

[15] 20-09-2016

[51] C1. 10 - 02

[54] 手錶

Watch

[73] HONG KONG PRECISION ELECTRONICS COMPANY LIMITED
Units 1-12, 10/F, Hope Sea Industrial Centre,
26 Lam Hing Street, Kowloon Bay, Kowloon,
HONG KONG

[74] CHAN, TANG & KWOK
Rooms 2503-04, 25/F.,
Shanghai Industrial Investment Building,
48-62 Hennessy Road, Wanchai, HONG KONG



- [11] 1601794.1
[15] 20-09-2016
[30] 23-03-2016 / EM / 003038991
[51] C1. 8 - 08
[54] 軌道螺栓
Track bolt
[73] FAUN Trackway Limited
Unit 6, Bryn Cefni Industrial Estate,
Llangefni, Isle of Anglesey, North Wales LL77 7XA,
UNITED KINGDOM
[74] So Keung Yip & Sin, Solicitors & Notaries, Agents for Trade
Marks, Patents & Designs
1009-1012, 10/F, Nan Fung Tower,
173 Des Voeux Road, Central,
HONG KONG

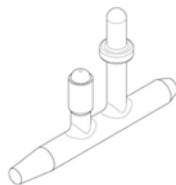

-
- [11] 1601795.4M001
[15] 20-09-2016
[30] 23-03-2016 / EM / 003039528
[51] C1. 25 - 02
[54] 車道面板
Roadway panel
[73] FAUN Trackway Limited
Unit 6, Bryn Cefni Industrial Estate,
Llangefni, Isle of Anglesey, North Wales LL77 7XA,
UNITED KINGDOM
[74] So Keung Yip & Sin, Solicitors & Notaries, Agents for Trade
Marks, Patents & Designs
1009-1012, 10/F, Nan Fung Tower,
173 Des Voeux Road, Central,
HONG KONG

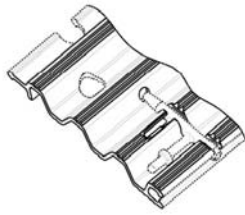

[11] 1601795.4M002

[15] 20-09-2016

[30] 23-03-2016 / EM / 003039528

[51] C1. 25 - 02

[54] 車道面板

Roadway panel

[73] FAUN Trackway Limited

Unit 6, Bryn Cefni Industrial Estate,

Llangefni, Isle of Anglesey, North Wales LL77 7XA,

UNITED KINGDOM

[74] So Keung Yip & Sin, Solicitors & Notaries, Agents for Trade
Marks, Patents & Designs

1009-1012, 10/F, Nan Fung Tower,

173 Des Voeux Road, Central,

HONG KONG

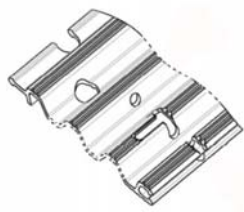

[11] 1601796.6M001

[15] 21-09-2016

[30] 23-03-2016 / EM / 003039346-0001

23-05-2016 / EM / 003148352-0001

[51] C1. 6 - 01

[54] 椅子

Chair

[73] Herman Miller Limited
Methuen Park, Chippenham,
Wiltshire, SN14 0GF,
UNITED KINGDOM

[74] Wilkinson & Grist
6th Floor, Prince's Building,
Chater Road,
HONG KONG



[11] 1601796.6M002

[15] 21-09-2016

[30] 23-03-2016 / EM / 003039346-0002

[51] C1. 6 - 01

[54] 椅子

Chair

[73] Herman Miller Limited
Methuen Park, Chippenham,
Wiltshire, SN14 0GF,
UNITED KINGDOM

[74] Wilkinson & Grist
6th Floor, Prince's Building,
Chater Road,
HONG KONG



[11] 1601797.8

[15] 21-09-2016

[51] C1. 14 - 03

[54] 數碼聲頻廣播時鐘收音機

Digital audio broadcasting clock radio

[73] WAI HANG ELECTRONIC COMPANY LIMITED

ROOM 1807-1808, 18/F., BLOCK B,

NEW TRADE PLAZA, 6 ON PING STREET, SIU LEK YUEN,

SHATIN, NEW TERRITORIES, HONG KONG

[74] IVAN WONG IP LIMITED

Unit 1406, 14th Floor, The Broadway,

54-62 Lockhart Road, Wanchai,

HONG KONG



[11] 1601798.0

[15] 21-09-2016

[51] C1. 9 - 03

[54] 急凍帆立貝的包裝袋

Packaging bag of frozen scallop

[73] Leader Marine Products Trading Limited

香港香港仔田灣海旁道7號興偉工業中心6樓613B室

[74] Leader Marine Products Trading Limited

香港香港仔田灣

海旁道7號

興偉工業中心6樓613B室



[11] 1601800.6M001

[15] 21-09-2016

[30] 22-03-2016 / US / 29/558,874

[51] C1. 9 - 03

[54] 食物容器

Food container

[73] ZUME Pizza, Inc.

250 Polaris Avenue,

Mountain View, California 94043,

UNITED STATES

[74] LETTERS & THOO LIMITED

Suite 1008, Prosperity Millennia Plaza,

663 King's Road, Quarry Bay,

HONG KONG

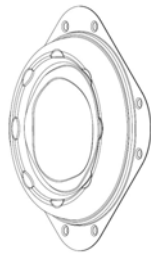

[11] 1601800.6M002

[15] 21-09-2016

[30] 22-03-2016 / US / 29/558,874

[51] C1. 9 - 03

[54] 食物容器

Food container

[73] ZUME Pizza, Inc.

250 Polaris Avenue,
Mountain View, California 94043,
UNITED STATES

[74] LETTERS & THOO LIMITED

Suite 1008, Prosperity Millennia Plaza,
663 King's Road, Quarry Bay,
HONG KONG



[11] 1601801.8M001

[15] 21-09-2016

[30] 22-03-2016 / US / 29/558,873

[51] C1. 9 - 03

[54] 食物容器蓋

Food container cover

[73] ZUME Pizza, Inc.

250 Polaris Avenue,
Mountain View, California 94043,
UNITED STATES

[74] LETTERS & THOO LIMITED

Suite 1008, Prosperity Millennia Plaza,
663 King's Road, Quarry Bay,
HONG KONG



- [11] 1601801.8M002
[15] 21-09-2016
[30] 22-03-2016 / US / 29/558,873
[51] C1. 9 - 03
[54] 食物容器蓋
Food container cover
[73] ZUME Pizza, Inc.
250 Polaris Avenue,
Mountain View, California 94043,
UNITED STATES
[74] LETTERS & THOO LIMITED
Suite 1008, Prosperity Millennia Plaza,
663 King's Road, Quarry Bay,
HONG KONG

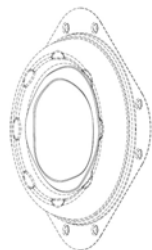

-
- [11] 1601920.0
[15] 12-10-2016
[51] C1. 28 - 03
[54] 手提按摩器
Handheld massager
[66] 1600887.8 / 10-05-2016
1600887.8 / 10-05-2016
[73] Tsui Chi Piu
香港柴灣
興民邨民逸樓3418室

Hong Xueqiang
香港柴灣
興民邨民逸樓3418室
[74] 徐志標
香港柴灣
興民邨民逸樓3418室





香港特別行政區政府知識產權署外觀設計註冊處
The Government of the Hong Kong Special Administrative Region
Designs Registry, Intellectual Property Department

根據註冊外觀設計條例第28條，下列註冊外觀設計因未繳續期費而停止有效。
各組記項按註冊外觀設計停止有效日期及註冊編號先後次序排列。

Registered designs ceased through non-payment of renewal fees under section 28 of the Registered Designs Ordinance. Entries are listed below under their expiry dates.

22-02-2017 – 27-02-2017

22-02-2017	1200302.4M020
0700539.0	1200302.4M021
1200293.3	1200302.4M022
1200294.5	1200302.4M023
	1200302.4M024
23-02-2017	1200302.4M027
0100456.7	1200302.4M028
1200297.2	1200302.4M029
1200298.4	1200302.4M030
1200301.2	1200302.4M031
1200303.6	1200302.4M033
1200296.0	1200302.4M034
1200304.8M007	1200302.4M037
1200304.8M006	1200302.4M039
1200304.8M005	1200302.4M040
1200304.8M003	1200302.4M041
1200304.8M002	1200302.4M042
1200304.8M001	1200302.4M044
1200300.0	1200302.4M046
1200302.4M001	1200302.4M049
1200302.4M002	1200302.4M011
1200302.4M004	1200302.4M018
1200302.4M005	1200302.4M025
1200302.4M006	1200302.4M032
1200302.4M008	1200302.4M036
1200302.4M009	1200302.4M045
1200302.4M010	1200302.4M016
1200302.4M012	1200302.4M026
1200302.4M014	1200302.4M035
1200302.4M015	1200302.4M047
1200302.4M017	1200305.1M001
1200302.4M019	1200305.1M002

1200305.1M004	1200310.1M002
1200305.1M008	1200310.1M001
1200305.1M009	1200310.1M004
1200305.1M010	1200316.4
1200305.1M011	1200317.6M002
1200305.1M012	1200317.6M013
1200305.1M003	1200317.6M015
1200305.1M005	
1200299.6	27-02-2017
1200304.8M004	0700566.7
1200302.4M003	1200322.6
1200302.4M013	1200318.8M001
1200302.4M048	1200318.8M002
1200302.4M007	
1200305.1M007	
1200305.1M006	

25-02-2017

0100450.4

26-02-2017

0210280.6
0210291.9M001
0700552.7
1200311.3
1200315.2
1200317.6M001
1200317.6M003
1200317.6M005
1200317.6M007
1200317.6M008
1200317.6M009
1200317.6M010
1200317.6M012
1200317.6M014
1200317.6M016
1200317.6M017
1200317.6M004
1200317.6M011
1200317.6M018
1200317.6M006
1200312.5
1200307.5
1200310.1M003



香港特別行政區政府知識產權署外觀設計註冊處
The Government of the Hong Kong Special Administrative Region
Designs Registry, Intellectual Property Department

根據註冊外觀設計規則第31條刪除的註冊外觀設計。各組記項按註冊外觀設計刪除日期及註冊編號先後次序排列。

Registered designs removed under section 31 of the Registered Designs Rules. Entries are listed below under their removal dates.

02-03-2017 – 07-03-2017

02-03-2017	1101450.7
9701298.7	1101446.9
0602218.0M001	
0602218.0M002	06-03-2017
0602218.0M003	0602237.0M003
0602218.0M006	0602249.5M001
0602218.0M007	0602249.5M002
0602218.0M008	0602244.4
0602218.0M009	0602237.0M002
0602218.0M004	0602237.0M001
0602218.0M005	1101455.8
1101433.1	1101458.4M002
1101435.6	1101458.4M003
1101434.3	1101458.4M005
1101442.0	1101458.4M007
1101440.6	1101458.4M009
1101437.0	1101457.2
1101436.8	1101458.4M008
1101438.2M001	
1101438.2M002	07-03-2017
1101439.4M001	9701299.9
1101439.4M002	0111294.5
1101439.4M003	0111297.2
	0602253.3M002
03-03-2017	0602252.1
0100005.2	0602304.2
0111280.6	1101461.0
0602222.8M001	1101465.9
1101447.1	1101459.6M001
1101448.3	1101459.6M002
1101449.5	1101459.6M003